

E-mail: info@powermechengeneering.com
Phone: 044 - 42614058, 24715461

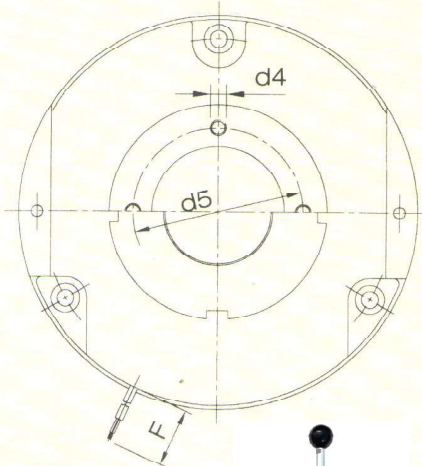

F for size :

- 06 to 14 = 410
- 16 to 25 = 610



Flange with G.pcd & 'H' holes

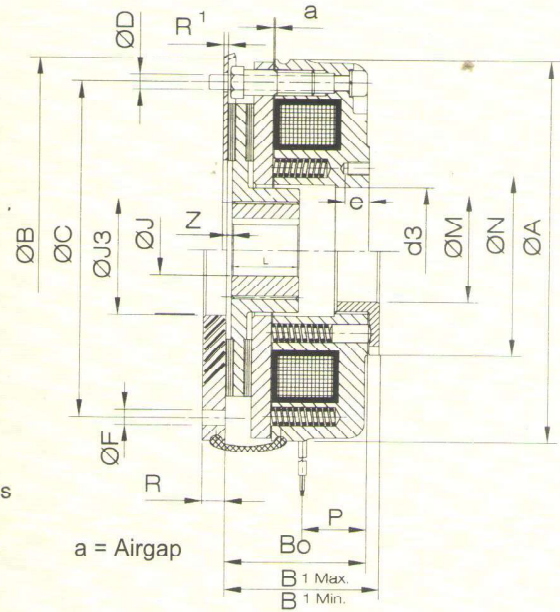

a = Airgap

Brake shown with Mounting Flange / Friction Plate & Rubber Seal

Mobile: +91 9940429288

PARAMETERS

e-mail: info@powermechengeneering.com

Size		06	08	10	12	14	16	18	20	25
Torque	M rat. [Nm]	4	8	16	32	60	80	150	260	400
Max. Speed	rpm [min ⁻¹]	3000	3000	3000	3000	3000	3000	1500	1500	1500
Input Power	P20 [w]	20	25	30	40	50	55	85	100	110
<p>Brake shown with Manual Hand Release</p>	ØA	87	105	130	150	165	190	217	254	302
	ØB	82	101.5	127	147	163.5	188.5	-	-	-
	B0	36.3	42.8	48.4	54.9	66.3	72.5	83.1	97.6	106.7
	B1 Max.	41.5	48.5	56	64.5	77	82.5	98	114	124
	B1 Min.	39.5	47	52.5	59	71.5	77.5	89	104.6	115.7
	ØC	72	90	112	132	145	170	196	230	278
	ØD	3 x M4	3 x M5	3 x M6	3 x M6	3 x M8	3 x M8	6 x M8	6 x M10	6 x M10
	ØF	3 x 4.5	3 x 5.5	3 x 6.6	3 x 6.6	3 x 9	3 x 9	4 x 9	6 x 11	6 x 11
	ØG	30 [#]	45 [#]	56	62	74	84	100	120	150
	ØH	3 x 4.5	3 x 5.5	3 x 6.6	3 x 6.6	3 x 9	3 x 9	6 x 9	6 x 9	6 x 11
	ØJ3	20/31 #	30/41#	40	45	55	65	75	90	120
	L	18	20	20	25	30	30	35	40	50
	ØM	24	26	33	40	48	56	64	73.1	95.1
	ØN	52	60	68	82	92	102	116	135	180
	P	12	14	15	18	20	25	28	35	35
	R	6	7	9	9	11	11	11	11	12.5
	R ₁	1.5	1.5	1.5	1.5	1.5	1.5	-	-	-
	z	1	1.5	2	2	2	2.25	2.75	3.5	4.5
a	0.2	0.2	0.2	0.3	0.3	0.3	0.4	0.4	0.5	
U	1	1	1	1	1	1.5	1.5	1.5	2	
d3 ^{H7}	25	32	42	50	60	68	75	85	115	
d4	4 x M4	4 x M5	4 x M5	4 x M5	4 x M6	4 x M6	4 x M8	4 x M10	4 x M10	
d5	37.7	49	54	64	75	85	95	110	140	
e	10	12	15	15	15	15	15	20	20	
ØJ ^{H7}	** 10,11 12,14 15	11,12 14,15 19,20	11,12 14,15 19,20	20,24 25	20,24 25,28 30,32	25,28 30,32 34,35	30,35 38,40 42	35,40 42,45 48	45,48 50,52 55,60,65	
** Standard bores										
*** max. bores										
Inertia	J[kg cm ²]	0.15	0.61	2.0	4.5	6.3	15	29	73	200
Weight	kg	0.85	1.45	2.50	4	5.6	8.4	12.6	19.5	31

IMPORTANT :

M rat.: Rated Brake torque in Nm, referred to = 100 min⁻¹
 1 Nm = 0.102 kgm = 0.737 lb. Ft.
 Standard voltages: 24 V.D.C.; 96 V.D.C.; 190 V.D.C.
 Other voltages on request.
 P: Coil power at 20° C
 Permissible voltage change +5% to -10%
 Recommended ISO shaft tolerances
 Up to Ø50 mm = k6
 Over Ø50mm = m6
 keyways to DIN 6885/ IS : 2048
 * Non std. Keyway
 'H' holes on 'G' pcd, only on request.

Friction Plate upto size 16 only
 # Applicable for flange bore 20/30

- # For size 06 ØJ ≤ 11, ØJ3=20
- " — ØJ ≥ 12, ØJ3=31
- # For size 08 ØJ ≤ 15, ØJ3=30
- " — ØJ ≥ 16, ØJ3=41

All dimensions are in mm

Specifications are subject to change without notice.

