

**DIMENSIONS**

Mobile: 9940429288

e-mail: info@powermechengineering.com

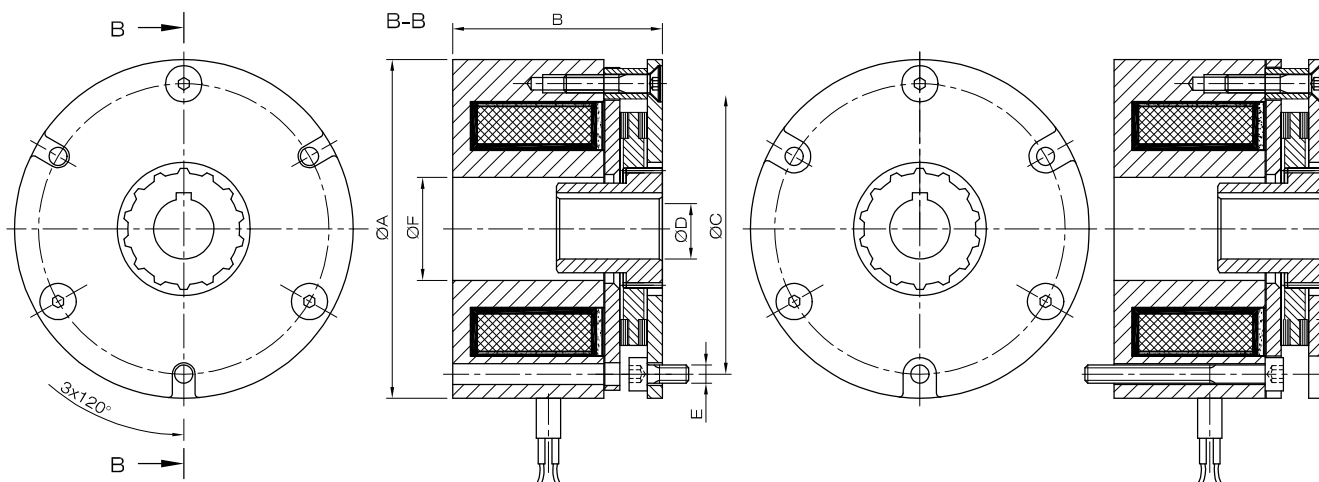

**PARAMETERS**

Size	Mk	P <sub>20°</sub>	D <sup>H7</sup>	$\varnothing A$	B	$\varnothing C$	$\varnothing E$	$\varnothing F$	H3	S <sub>10</sub> <sup>2</sup>	S <sub>10</sub> max.
03	0.5	9	6/7/8	56	32	48	3xM3	17	15	0.15 ±0.1	0.4
04	1	12.5	7/8/10	65	34	58	3xM3	20	15		
05	2	16	8/10/11	75	36	66	3xM4	24	15		

<sup>1</sup> Without keyway

<sup>2</sup> Minimum air gap, the actual value is determined by the sum tolerances of the individual components

Keyways to DIN 6885/ IS : 2048

Length of the connecting cable : 400 mm.

All Dimensions are in mm.

Subject to modifications.

Voltages: 24V, 205 V, (105V)

M<sub>k</sub> : Rated torque for the brake in Nm., referred to  
Δn = 100 rpm

**Caution !** The braking torque depends on the speed

P<sub>20</sub> : Coil power at 20° C in W

**POWERMECH ENGINEERING**

Mobile : +91 99404 29288

Phone : 044 42614058 / 044 24715461

Email : info@powermechengineering.com

Website : www.powermechengineering.com

www.powermechengineering.in